

RADIUS	R TOL	POWER	IRRG	CA	DIA	DIA TOL	MATERIAL	INDEX	CT	CT TOL
140.54 CX	±0.25%	5	2	90%	75.00	-0.1/-0.2	N-BK7	517-642	13.70	±0.10
112.81	±0.25%	5	2	90%	75.00	+0.05/-0.1	N-SF2	648-338	5.00	±0.10
430.15 CX	±0.25%	5	2	90%						

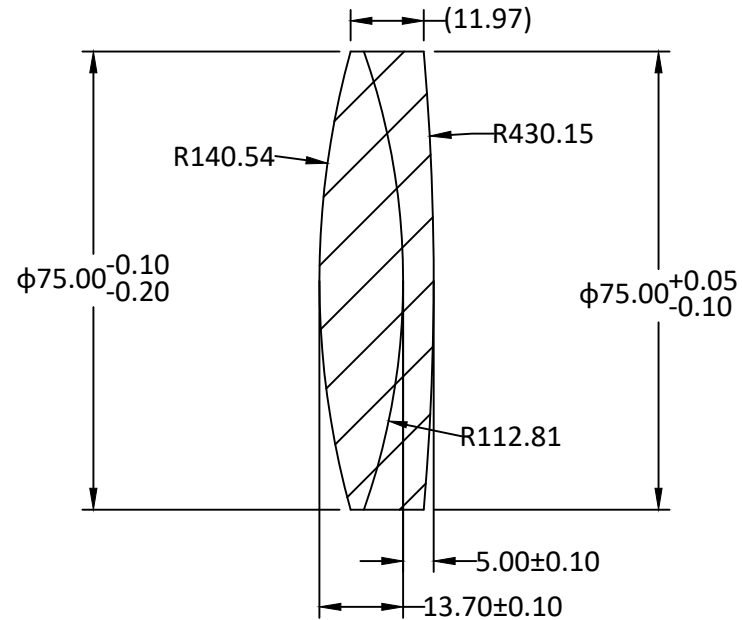
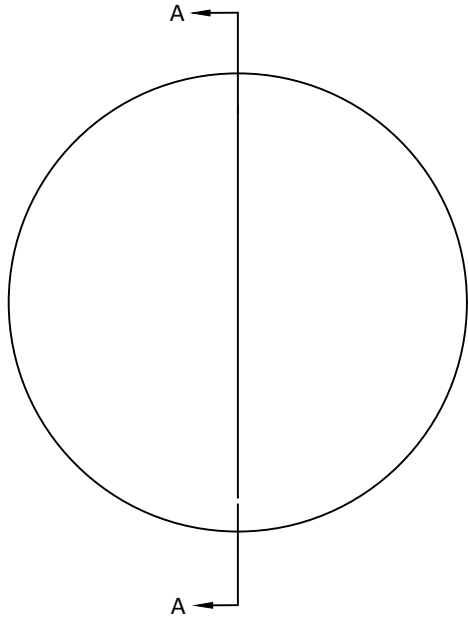

SECTION A-A

Notes:

1. ALL DIMENSIONS IN MM
2. TOLERANCE UNLESS SPECIFIED  $\pm 0.10$
3. MATERIAL GRADE B, FA PER MIL-G-174, SCHOTT OR EQUIVALENT, RoHS COMPLIANT
4. MANUFACTURE PER MIL-PRF-13830
5. POLISH TO TESTPLATE WITHIN POWER AND IRREGULARITY INDICATED (FRINGES)
6. SURFACE QUALITY : 60-40 SCRATCH-DIG
7. CHAMFER EDGES:  $0.5 \times 45^\circ$  MAX UNLESS SPECIFIED
8. CENTRATION TOLERANCE: 3.0' MINUTES MAX
9. EFL: 250MM  $\pm 2\%$
10. DESIGN WAVELENGTH: 587.6NM
11. COATING: S1 & S3: SINGLE LAYER MGF2@550NM PER MIL-C-675C, MODERATE ABRASION
12. CEMENT USUNG NORLAND NOA61 OR EQUIVALENT

UNLESS OTHERWISE SPECIFIED:		NAME	DATE	
DIMENSIONS ARE IN mm TOLERANCES: FRACTIONAL $\pm$ ANGULAR: $\pm 3$ ARC MIN TWO PLACE DECIMAL: $\pm 0.10$ THREE PLACE DECIMAL: $\pm 0.05$		DRAWN	Sally Song 12.10.24	
INTERPRET GEOMETRIC TOLERANCING PER:		CHECK		TITLE:
MATERIAL		ENG APPR.		DIAMETER 75.00MM, EFL 250MM, MgF2 COATED, ACHROMAT LENS
FINISH		MFG APPR.		SIZE DWG.NO. REV
DO NOT SCALE DRAWING		QA	Ann Chen 12.18.24	<b>A</b> L-AC1020250075 <b>0</b>
PROJECT NO.		COMMENTS		SCALE: 1:1 WEIGHT: SHEET 1 OF 1